

Break-out Space | Shared Support Room

- Room is used as a collaboration area for primarily the same grade level.
- Connects directly with adjacent classrooms.
- Can be expanded for larger group settings by opening both moving partitions.
- The partition walls could be used as another teaching wall.
- Room can be used for smaller groups or for teaching planning.

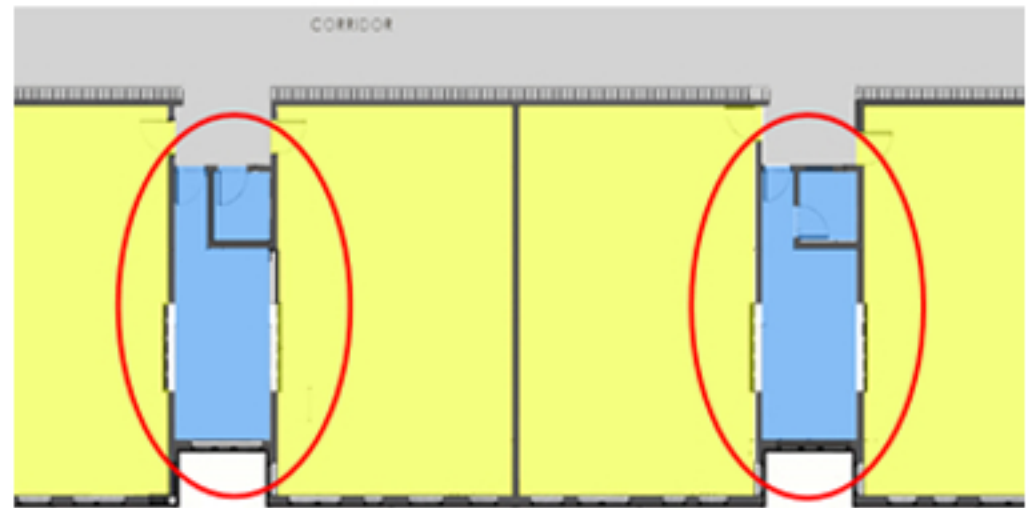
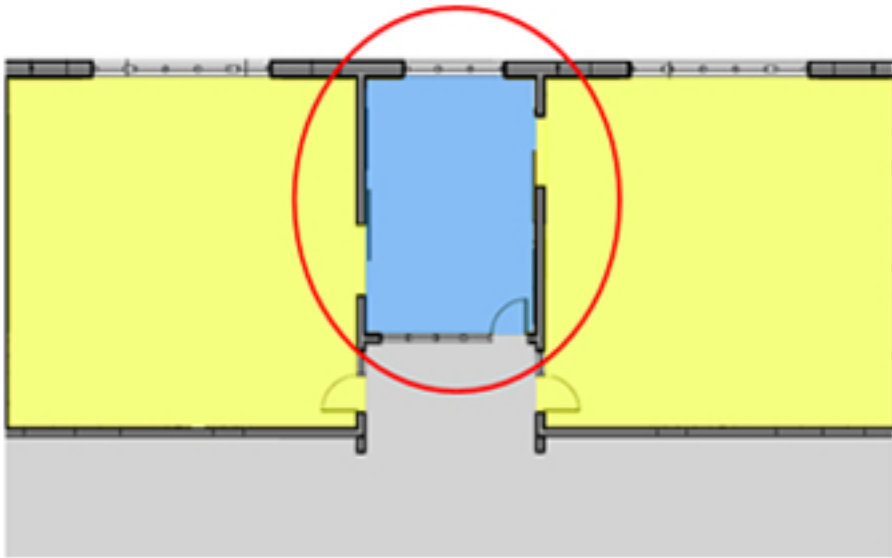

Classrooms – 900 SF
Break-out Space – 300 SF

Classrooms – 970 SF
Break-out Space – SF included
in classroom SF

Key
■ Classrooms
■ Break-out Spaces